

FILED  
GREENVILLE CO. S.C.  
JUN 16 2 30 PM '80  
DONNIE S. TANKERSLEY  
R.M.C.

SOUTH ROCKVIEW DRIVE  
WATER IN ST. RW

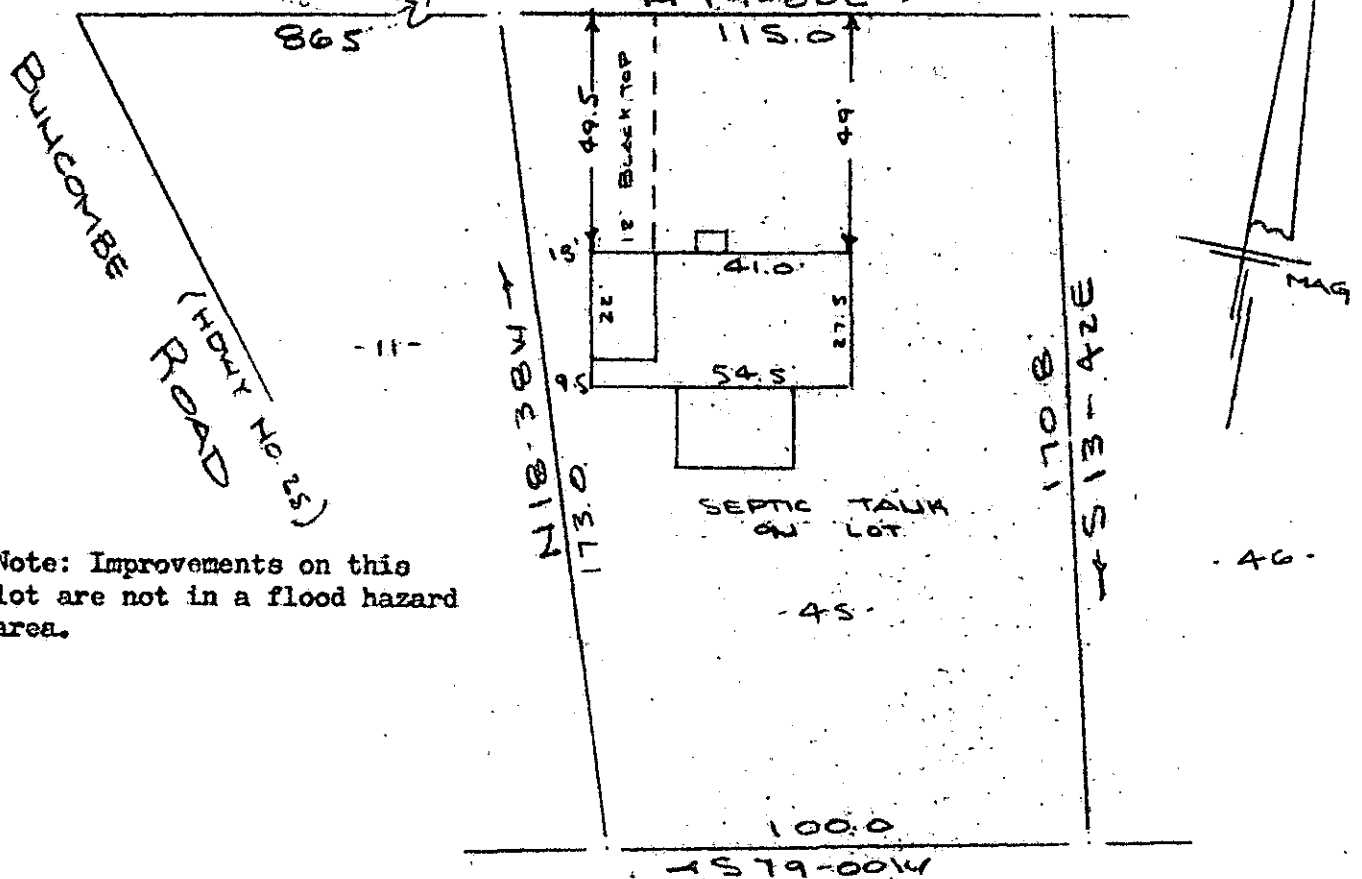

Note: Improvements on this lot are not in a flood hazard area.

- M G. BATSON -                      - JOHN BATSON -

PROPERTY OF  
**ANDREA BRENNER & WILLIAM B. WILLIAMS**  
near GREENVILLE, S.C.  
SCALE 1" = 40'                      21 MAY 1980

SC70  
UN1680  
1274

This is to certify that on the 21st day of May, 1980, I surveyed the property shown on this plat, being known as lot 45 on plat of PROPERTY OF ANDREA BRENNER & WILLIAM B. WILLIAMS recorded in the REC Office Greenville County, S. C., in Plat Book        at Pg.        and that the property lines, walls and buildings are as shown hereon, and that the walls and buildings located on said lot do not encroach or project on adjacent street or property, and that no adjacent walls or buildings encroach or project on said premises, and no power lines cross this property except as shown hereon.

✓ 8-B-63

JUN 16 1980

*R. B. Bruce*  
R. B. Bruce, R.S. 4/1978

35844

CAROLINA SURVEYING CO.  
112 Early St.  
Greenville, S. C.

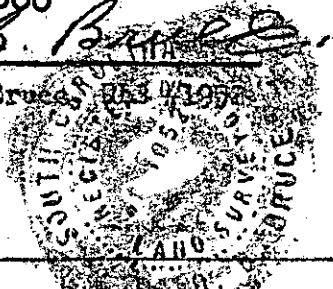

3.0001